

3. Fijación al mástil / Fixation au mât / Clamping to the mast

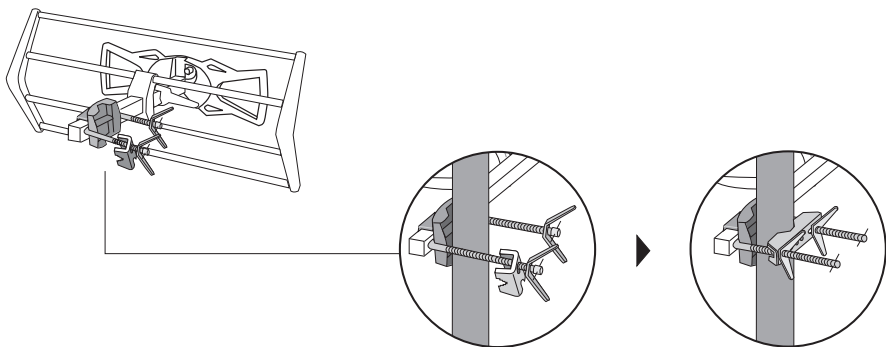

4. Conexión del cable coaxial / Raccordement du câble coaxial / Connecting the coaxial cable

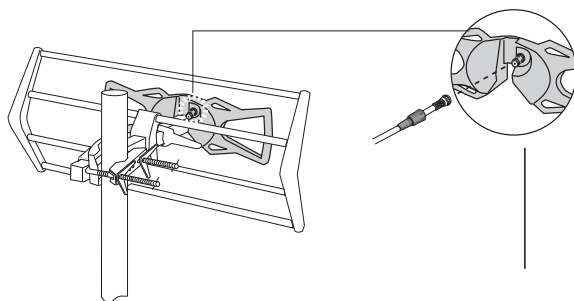
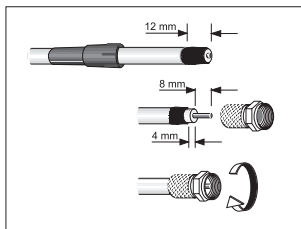

par de apriete máx : 10kg.cm
serrer sans excéder : 10kg.cm
torque max : 10kg.cm

Accesorios suministrados
Accessoires fournis
Accessories supplied

 Conector F roscable
Connecteur F à visser
Screw-on F plug

 Capuchón protector
Capuchon protecteur
Protection cap

FLASHD NANO

ANTENAS DE RECEPCIÓN TV UHF COMPACTAS
ANTENNES DE RÉCEPTION TV UHF COMPACTS
COMPACTS UHF TV RECEIVING ANTENNAS



Flashd NANO LTE (HDTN790V) Ref. 1813
Flashd NANO (HDT511V) Ref. 1800

V = Verde / Vert / Green



1813



1800

Características Técnicas / Données Techniques / Technical Data

— Modelos / Modèles / Models :

Flashd NANO (HDT511V) ▶21-69 (470-862 MHz)
Flashd NANO LTE (HDTN790V) ▶21-60 (470-790 MHz)

— Relación D/A / Rapport AV/AR / Front-to-Back ratio : ≥16 dB

— Ángulo de apertura / Angle d'ouverture / Beamwidth : 60° (H) ; 80° (V)

— Carga del viento / Charge au vent / Windload : 15 N (130 km/h) ; 20 N (150 km/h)

— Ganancia / Gain :

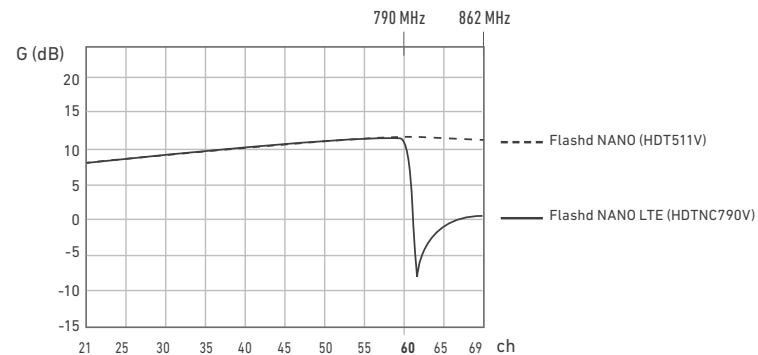

1. Preparación de la antena / Préparation de l'antenne / Preparing the antenna

1.1) Colocación del reflector / Installation du réflecteur / Installing the reflector

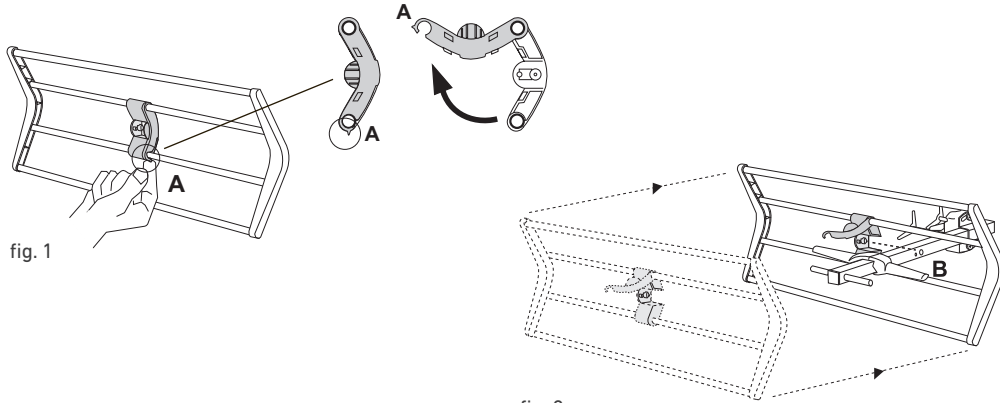

fig. 1

fig. 2

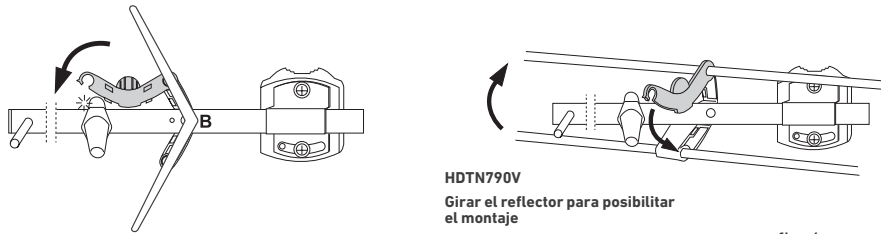

fig. 3

fig. 4

HDTN790V
Girar el reflector para posibilitar el montaje
 To allow assembly turn the reflector
 Tourner le réflecteur pour permettre l'assemblage

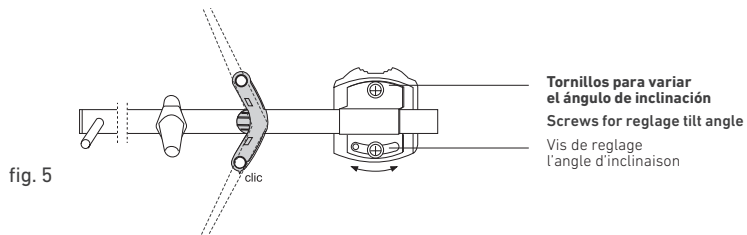
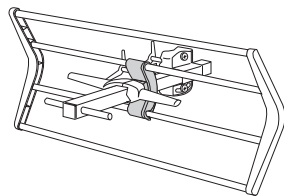

fig. 5

Tornillos para variar el ángulo de inclinación
Screws for réglage tilt angle
 Vis de réglage l'angle d'inclinaison



2.1) Colocación del dipolo / Installation du dipôle / Installing the dipole

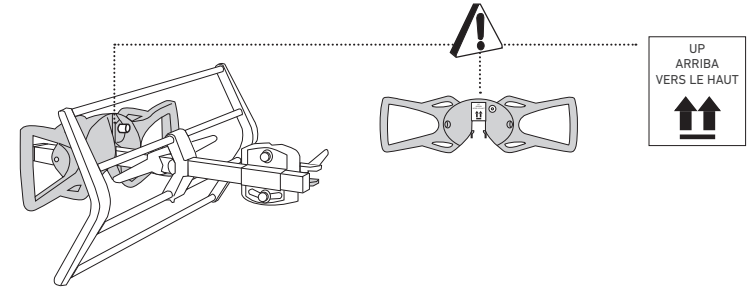

fig. 1

fig. 2

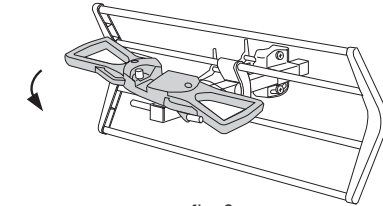
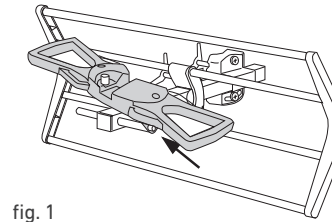
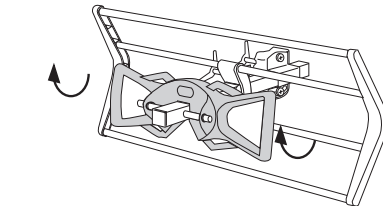
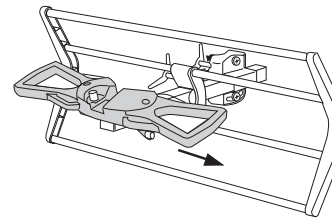

fig. 3

fig. 4



2. Polarización vertical / Polarisation verticale / Vertical polarization

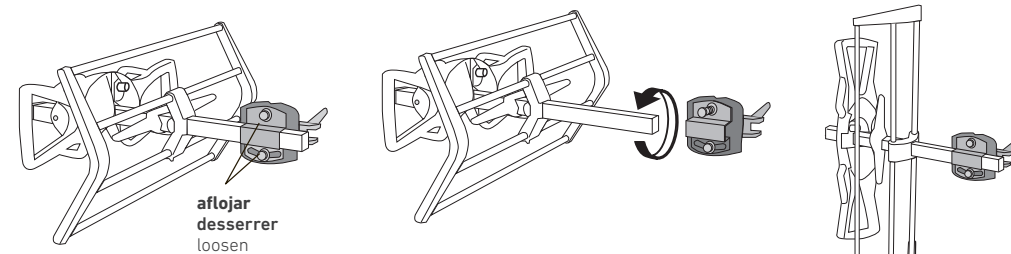

fig. 1

fig. 2

fig. 3

Hoja No Imprimible

PLEGADO DEL MANUAL

formato DIN A-4

